

Simplex Interlock Controls

ACIL10



The door control system ACIL10 is the simple and complete solution to manage the interlock sequences of two to four doors in contamination controlled areas.

Simple Customisation

The centrally located interlock control panel can be programmed using dip-switches located internally within the housing of the panel. Numerous different combinations of logic functions are available with pre-loaded common functions.

Intelligent Controls

Control panel can be configured to control 2 to 4 doors, and come with integrated timers to control pressurisation times and other essential functions. Using fast fail-safe connections, trouble shooting and replacing parts is now 80% faster and more reliable. Configuration of the interlock controls is performed using the on-board dip-switches.

Control panel also provides for commands for automated processes, and has a built in input for a card reader and emergency unlock.

Numerous Configurations

The ACIL10 provides numerous configurations, including material airlocks, personnel airlocks and passageway logic. Locks supported include Electric strike locks, Piston locks and Electromagnetic locks. Door mounted red or green traffic lights can be lit when the door is locked, depending on clients requirements. Timer can be programmed from 0 to 99 minutes. The ACIL10 can also be configured to communicate with the site BMS system, depending on the specific requirements and has a lengthy proven track record with many years of proven service in the cleanroom / controlled environments sectors. The ACIL10 has a wide range of applications, including Cleanroom, Healthcare, Laboratory, Food Preparation and Food manufacture, and Controlled Environments.

Call us:

1890 274 273

Visit us:

Unit C Purcellsinch Industrial Estate,
Old Dublin Road, Kilkenny, R95 EH52

Email / Website:

admin@actec.ie
www.actec.ie

Interlocks / Door Hardware / Activation / Safety Devices

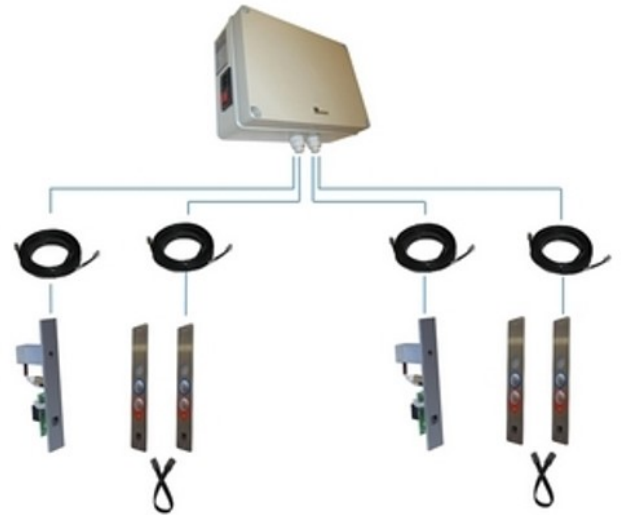
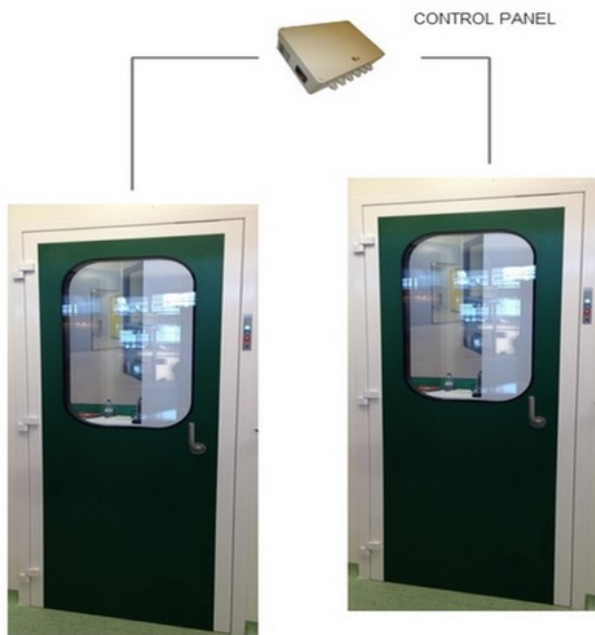

Technical Specifications:

Power:	230Vac / 24Vdc (12Vdc only on demand)
Max Current Consumption:	1A @ 230Vac
Traffic light Output:	100mA @ 24Vdc
Lock Output:	250mA @ 24Vdc
No. of Doors Controlled:	2 to 4 doors
Control Panel Dimensions:	342 x 253 x 129mm
Enclosure Construction:	Plastic (halogen free material)
Working Temperature:	-5° to +50° C
Certifications:	2004/108/EC— EN61000-6-2 (2005) EN61000-6-3 (2007) & A1 (2011) EN60950-1:2006 & A11:2009 + A1:2010 & A12:2011

Inputs:	Plug or Wire Connection Door Status Remote Door Unlocking
Outputs:	Locks / Indicators Door Automation Operator



Benefits of using ACIL10

- Compact, Easy to use and low maintenance solution for interlock controls
- Good quality / price ratio
- Suitable for a wide variety of interlocking applications
- Easy to install thanks to plug and play connections
- Easy to configure by adjusting the dipswitches on the control panel circuit board

Contact us for more information